

FORM B – BUILDING

MASSACHUSETTS HISTORICAL COMMISSION
MASSACHUSETTS ARCHIVES BUILDING
220 MORRISSEY BOULEVARD
BOSTON, MASSACHUSETTS 02125

Photograph



View looking north.

Locus Map

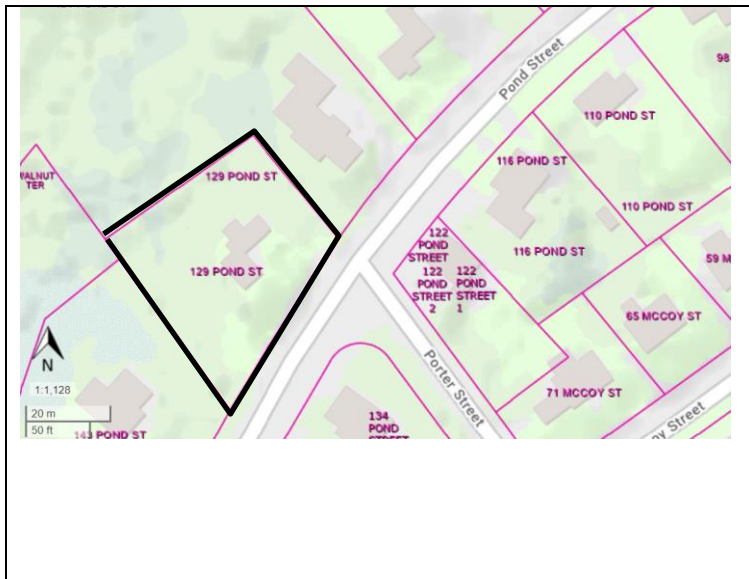

Recorded by: Stacy Spies

Organization: Avon Historical Commission

Date (month / year): December 2022

Assessor's Number USGS Quad Area(s) Form Number

C5/ 3/ 2/ 1

Blue Hills

AVO.60

Town/City: Avon

Place: (*neighborhood or village*):

Address: 129 Pond Street

Historic Name: Samuel and Roxanne Crane House

Uses: Present: Single Family Dwelling

Original: Single Family Dwelling

Date of Construction: ca. 1816

Source: Deed

Style/Form: No Style

Architect/Builder: Not Known

Exterior Material:

Foundation: Stone, Cut

Wall/Trim: Wood Shingles, Wood Clapboard / Wood Trim

Roof: Asphalt Shingle

Outbuildings/Secondary Structures: None

Major Alterations (*with dates*): Replacement vinyl sash windows (late 20th or early 21st C)

Condition: Good

Moved: no ☒ yes ☐ **Date:**

Acreage: 0.38

Setting: Located on a suburban residential street.

INVENTORY FORM B CONTINUATION SHEET

AVON

129 POND ST

MASSACHUSETTS HISTORICAL COMMISSION

220 MORRISSEY BOULEVARD, BOSTON, MASSACHUSETTS 02125

Area(s) Form No.

AVO.60

☐ Recommended for listing in the National Register of Historic Places.

If checked, you must attach a completed National Register Criteria Statement form.

Use as much space as necessary to complete the following entries, allowing text to flow onto additional continuation sheets.

ARCHITECTURAL DESCRIPTION:

Describe architectural features. Evaluate the characteristics of this building in terms of other buildings within the community.

The house is located on a gently-sloping site and is oriented to the southeast and the street. A gravel driveway leads from the street to the east end of the house. The frame house consists of a 1-story, 3-bay main block and a 1-story ell attached to the north corner of the main block. The house rests on a granite slab foundation and rises to a side-gabled roof with an interior brick chimney at the east end of the roof ridge. A shallow box cornice is located along the façade; side elevations have no overhang.

The main block appears to be a two-rooms-deep half-house covered with wood shingles on the façade. The west elevation is covered with wood shingles at the first story and wood clapboards in the gable peak. The east elevation is covered with wood clapboards on the east elevation. The façade contains two 2/2 wood sash windows and paneled wood door. A granite step is located at the entrance. The west elevation contains two 1/1 sash windows centered under the gable peak. The east elevation contains two widely-spaced windows; the south window contains 6/6 wood sash and the north window contains 2/2 wood sash. 6/6 wood sash windows are centered in the east and west gable peaks. Window and door surrounds are wide, unadorned boards.

The offset ell rests on a cut stone foundation and is capped with a slender parged masonry chimney atop the roof ridge. The ell is three bays wide and one bay deep and covered with wood clapboards trimmed with cornerboards. Poured concrete steps lead to the entrance at the west end of the ell's façade. The entrance contains a paneled wood door with a light in the top half. A 2/2 wood sash window is located beside the door. 1/1 vinyl sash replacement windows are located in the east end of the ell's façade and east elevation. Window and door surrounds are wide, unadorned boards.

Interior inspections were beyond the scope of this survey, but a closer examination of surviving framing, floorplans, and interior features and finishes by an architectural historian with expertise in early Massachusetts building technology could provide additional insights into a likely original construction date and on the physical evolution of the building over time.

HISTORICAL NARRATIVE

Discuss the history of the building. Explain its associations with local (or state) history. Include uses of the building, and the role(s) the owners/occupants played within the community.

The construction of the house at 129 Pond Street can be traced back to circa 1816. In 1816, Samuel Crane (1795-1864) married his wife, Roxanne Crane (*nee* Crane) (1796-1867). (As part of this survey, the chain of title was researched back to 1780, when Joshua Howard of Braintree sold seven acres here to Nathaniel Hammond of Stoughton.¹ However, no deeds mention a building on the property until the second quarter of the 19th century.² More research is recommended.) Samuel Crane was born in Bradford, New Hampshire and worked as a laborer and as a boot maker.

In 1866, Samuel and Roxanne Crane's son, Samuel Lewis Crane, sold the house to Andrew F. Bride.³ Andrew F. Bride (1825-1892)⁴ worked in a boot factory and lived here with his wife, Mary, and son, Frank. Mary Bride (1829-1912)⁵ sold the house in 1906 to Martin L. French (1858-1920)⁶ with the provision that she be allowed to remain in the house for the remainder of her life

¹ Suffolk County Registry of Deeds Book 5, p. 17.

² An 1850 mortgage deed confirms the existing building's presence on this lot. Norfolk County Registry of Deeds Book 194, p. 504.

³ Norfolk County Registry of Deeds Book 371, p. 39 [76].

⁴ <https://www.findagrave.com/memorial/102204554/andrew-f-bride>. Accessed Dec. 12, 2022.

⁵ <https://www.findagrave.com/memorial/102204742/mary-r-bride>. Accessed Dec. 12, 2022.

⁶ <https://www.findagrave.com/memorial/144299762/martin-l-french>. Accessed Dec. 12, 2022.

INVENTORY FORM B CONTINUATION SHEET

AVON

129 POND ST

MASSACHUSETTS HISTORICAL COMMISSION

220 MORRISSEY BOULEVARD, BOSTON, MASSACHUSETTS 02125

Area(s) Form No.

AVO.60

and that he would provide "all food supplies and fuel" as she needed.⁷ The 1910 census recorded 80-year-old widow Mary Bride here with carpenter Martin L. French, a 58-year-old widower.

Stephen Emery owned the house from 1920 until 1968.⁸ Emery worked in a shoe factory and lived here with his wife, Alice, and their children.

BIBLIOGRAPHY and/or REFERENCES

City Directories.

Findagrave.com.

Fisher, Nathaniel. "A Plan of the Town of Stoughton." 1794. Massachusetts State Archives.

Hanna, William F. *The Story of Avon*. Avon: Avon Centennial Committee, 1988.

Hodges, Joseph. Map of Stoughton. 1830. Massachusetts State Archives.

Massachusetts Census. Ancestry.com.

Massachusetts Vital Records.

Norfolk County Registry of Deeds.

Robinson, E. *Robinson's Atlas of Norfolk County, Massachusetts*. New York: E. Robinson, Publisher, 1888.

Sherman, G.A. *Atlas of Norfolk County*. New York: Comstock & Cline, 1876.

Suffolk County Registry of Deeds.

Talbot, Newton. [Buildings standing in Stoughton in 1775]. 1929. <https://stoughtonhistory.com/1775map.htm>.

Town of Avon. Tax Assessor records.

United States Census. Ancestry.com.

Walling, Henry Francis. *Map of Norfolk County, Mass.* Boston: Smith & Bumstead, 1858.



View looking northwest.

⁷ Norfolk County Registry of Deeds Book 1041, p. 32.

⁸ Norfolk County Registry of Deeds Book 1456, p. 591 and Book 4560, p. 691.