

FORM B – BUILDING

MASSACHUSETTS HISTORICAL COMMISSION
MASSACHUSETTS ARCHIVES BUILDING
220 MORRISSEY BOULEVARD
BOSTON, MASSACHUSETTS 02125

Photograph



View looking southeast.

Locus Map

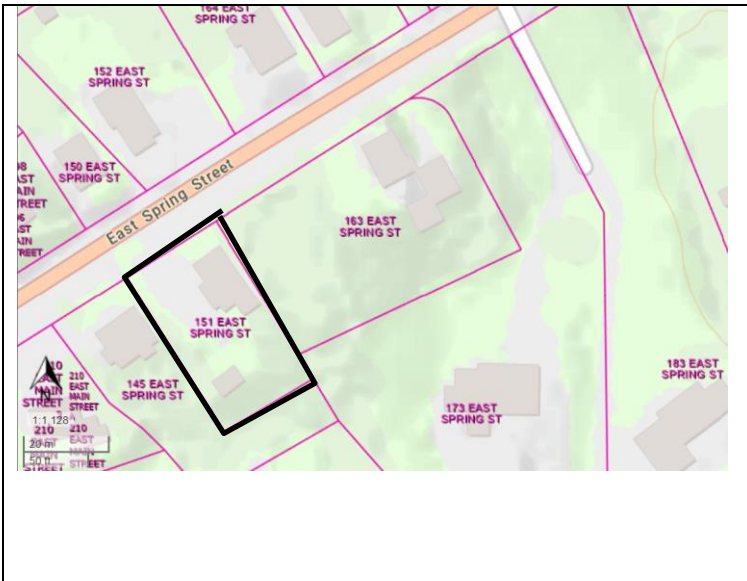

Recorded by: Stacy Spies

Organization: Avon Historical Commission

Date (month / year): December 2022

Assessor's Number USGS Quad Area(s) Form Number

D5/ 5/ 8/ 1

Blue Hills

AVO.43

Town/City: Avon

Place: (*neighborhood or village*):

Address: 151 East Spring Street

Historic Name: Willie Littlefield House

Uses: Present: Multiple Family Dwelling

Original: Multiple Family Dwelling

Date of Construction: ca. 1889-1898

Source: Deed; Marriage Date

Style/Form: Victorian

Architect/Builder: George A. Edwards, likely

Exterior Material:

Foundation: Stone, Uncut

Wall/Trim: Asbestos Shingles / Wood Trim

Roof: Asphalt Shingle

Outbuildings/Secondary Structures: Shed

Major Alterations (*with dates*): Asbestos shingles, Replacement vinyl sash windows (late 20th C or early 21st C); Shed-roof projections at side elevations and shed dormers (late 20th C).

Condition: Fair

Moved: no ☒ yes ☐ **Date:**

Acreage: 0.26

Setting: Located at a busy intersection at the four-lane, divided Route 28. Surrounding buildings are 2-story frame dwellings constructed during the 18th-20th centuries.

INVENTORY FORM B CONTINUATION SHEET

AVON

151 EAST SPRING ST.

MASSACHUSETTS HISTORICAL COMMISSION

220 MORRISSEY BOULEVARD, BOSTON, MASSACHUSETTS 02125

Area(s) Form No.

AVO.43

☐ Recommended for listing in the National Register of Historic Places.

If checked, you must attach a completed National Register Criteria Statement form.

Use as much space as necessary to complete the following entries, allowing text to flow onto additional continuation sheets.

ARCHITECTURAL DESCRIPTION:

Describe architectural features. Evaluate the characteristics of this building in terms of other buildings within the community.

Located on a level lot covered with lawn, the house is oriented to the north toward the street. An asphalt paved driveway and parking area fills the area between the house and the west lot line. A second parking area is located adjacent to the street. The 2-story building rests on a stone foundation and rises two stories to a front-gabled roof with overhanging eaves. An interior brick chimney rises from the west roof slope. The façade (north elevation) contains a small porch supported by turned wood columns with jigsawn wood brackets and enclosed with a square-section balustrade. Turned wood pilasters frame the Colonial Revival-style entry door (late 20th C). A 2-story box bay window fills the west half of the façade; a second, identical box bay is located on the west elevation. At the first story, the windows consist of a 1/1 wood sash window framed by slender 1/1 wood sash windows. At the second story, the windows consist of three slender vinyl sash replacement windows. A flared pent roof separates the first and second levels of the box bay. Small wood decorative brackets line the box bay frieze. The second-story brackets are more elaborate than those at the first story and echo the small decorative brackets tucked under the eaves at the corners of the building. The remaining windows are 1/1 vinyl sash and slider construction. 1-story, shed-roof projections with concrete block foundations and the shed dormers appear to be late 20th-century additions. The application of the asbestos shingles obscured much of the window surrounds.

HISTORICAL NARRATIVE

Discuss the history of the building. Explain its associations with local (or state) history. Include uses of the building, and the role(s) the owners/occupants played within the community.

151 East Spring Street was likely constructed circa 1889-1898 for William W. Littlefield (1869-1943). Willie Littlefield, as he was known, purchased this lot of land¹ in 1889 and lived here with his parents, Horace, a police officer, and Mary. In 1898, Willie Littlefield married Emma F. Stetson (1875-1944). Emma Littlefield worked as a self-employed milliner, while Willie Littlefield worked as a butter and dairy product dealer, as a bookkeeper for a grain and oil dealer, as treasurer of the Avon Lumber Company, and as Avon town treasurer circa 1917-1921. It appears that the Littlefield family made this their residence for about 15 years, after which time it became a rental property. (By 1908, Willie and Emma Littlefield were living at West Main Street.) In 1943, Willie Littlefield's estate sold the property to Edward and Lydia P. Salemi, who owned the property until 1979.² Edward Salemi worked as a cutting die forger for Brockton Cutting and Die Company. The Salemi family lived on the first floor and rented out the second floor.

151 East Spring Street was likely constructed by house carpenter George A. Edwards (1857-1916).³ It appears that Edwards constructed several houses on speculation near the intersection of East Main Street and East Spring Street 1890-1900. George A. Edwards' parents, George K. Edwards (a former carpenter turned grocer) and Eliza A. Edwards, purchased property here⁴ and subdivided it as the houses were constructed.

BIBLIOGRAPHY and/or REFERENCES

City Directories.

Cook, Louis A. *History of Norfolk County, Massachusetts, 1622-1918*. Vol. 1. New York, N.Y.: The S.J. Clarke Publishing Company, 1918.

Findagrave.com.

¹ Norfolk County Registry of Deeds Book 631, p. 480.

² Norfolk County Registry of Deeds Book 2447, p. 263 and Book 5626, p. 95.

³ Findagrave.com Memorial #162605812. Accessed Oct. 14, 2022.

⁴ Norfolk County Registry of Deeds Book 618, p. 101.

INVENTORY FORM B CONTINUATION SHEET

AVON

151 EAST SPRING ST.

MASSACHUSETTS HISTORICAL COMMISSION

220 MORRISSEY BOULEVARD, BOSTON, MASSACHUSETTS 02125

Area(s) Form No.

AVO.43

Hanna, William F. *The Story of Avon*. Avon: Avon Centennial Committee, 1988.
Mason Membership Cards. Ancestry.com.
Massachusetts Vital Records.
Massachusetts Census. Ancestry.com.
Norfolk County Registry of Deeds.
Robinson, E. *Robinson's Atlas of Norfolk County, Massachusetts*. New York: E. Robinson, Publisher, 1888.
Town of Avon. Tax Assessor records.
United States Census. Ancestry.com.



Entrance.



Detail, brackets at eaves.