

# FORM B – BUILDING

MASSACHUSETTS HISTORICAL COMMISSION  
MASSACHUSETTS ARCHIVES BUILDING  
220 MORRISSEY BOULEVARD  
BOSTON, MASSACHUSETTS 02125

## Photograph



View looking north.

## Locus Map

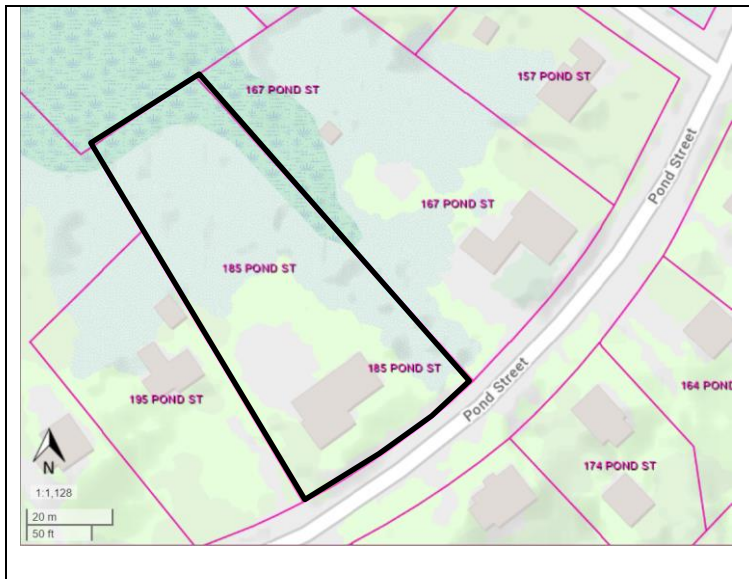

Assessor's Number USGS Quad Area(s) Form Number

C5/ 1/ 15/ /

Blue Hills

AVO.65

**Town/City:** Avon

**Place:** (*neighborhood or village*):

**Address:** 185 Pond Street

**Historic Name:** Ebenezer and Abigail Crane House

**Uses:** Present: Single Family Dwelling

Original: Single Family Dwelling

**Date of Construction:** Before 1797

**Source:** Deed

**Style/Form:** No Style

**Architect/Builder:** Not Known

**Exterior Material:**

Foundation: Stone, Cut

Wall/Trim: Vinyl Siding / Vinyl Trim

Roof: Asphalt Shingle

**Outbuildings/Secondary Structures:** None

**Major Alterations** (*with dates*): Shed dormers (late 19<sup>th</sup>-early 20<sup>th</sup> C); Vinyl siding, replacement metal doors, and replacement vinyl sash windows (late 20<sup>th</sup> C or early 21<sup>st</sup> C); 1-story lateral ell and 2-story rear ell (late 20<sup>th</sup>-early 21<sup>st</sup> C)

**Condition:** Fair

**Moved:** no ☒ yes ☐ **Date:**

**Acreage:** 0.83

**Setting:** Located on a suburban residential street.

**Recorded by:** Stacy Spies

**Organization:** Avon Historical Commission

**Date** (*month / year*): December 2022

# INVENTORY FORM B CONTINUATION SHEET

AVON

185 POND STREET

MASSACHUSETTS HISTORICAL COMMISSION

220 MORRISSEY BOULEVARD, BOSTON, MASSACHUSETTS 02125

Area(s) Form No.

AVO.65

☐ Recommended for listing in the National Register of Historic Places.

*If checked, you must attach a completed National Register Criteria Statement form.*

*Use as much space as necessary to complete the following entries, allowing text to flow onto additional continuation sheets.*

## ARCHITECTURAL DESCRIPTION:

*Describe architectural features. Evaluate the characteristics of this building in terms of other buildings within the community.*

The house is located on a level lot close to the street and oriented to the south, toward the street. The lot is covered with lawn near the house; the remainder of the lot is wooded. An asphalt-paved driveway leads past the house's west elevation to a parking area behind the house. The 1-story frame house rests on a cut-stone foundation and rises to a low, side-gabled roof. Two shed dormers, each containing two sash windows, are located on the south roof slope. An off-center, slender brick chimney is located atop the roof ridge. The house has overhanging eaves along the façade and no overhang on the side elevations. The house is three bays wide and two bays deep with a pair of windows in each gable peak. The center entrance contains a pressed-panel metal door with half-height sidelights. Two cut-stone steps lead to the entrance. Wood-frame bay windows are located on either side of the entrance. A large 1-story ell, approximately the same size as the original house, is attached to the east elevation and rests on a poured concrete foundation. The ell's south elevation contains two pairs of vinyl sash windows with internal faux muntins.

The building's low, 1-story volume, symmetrical façade and two-bays deep form support a possible 18<sup>th</sup>-century construction date. The building has a low level of integrity due to the loss of original materials. Interior inspections were beyond the scope of this survey, but a closer examination of surviving framing, floorplans, and interior features and finishes by an architectural historian with expertise in early Massachusetts building technology could provide additional insights into a likely original construction date and on the physical evolution of the building over time.

## HISTORICAL NARRATIVE

*Discuss the history of the building. Explain its associations with local (or state) history. Include uses of the building, and the role(s) the owners/occupants played within the community.*

The house at 185 Pond Street is part of a group of four houses owned by the extended Crane family in the nineteenth century (i.e., 129, 160, 167 and 185 Pond Street). Ebenezer Crane purchased a house and barn in this general area from Caleb Howard in 1797;<sup>1</sup> it cannot be confirmed that this is the house conveyed in that deed. (Caleb Howard owned a large amount of property in the area and also owned a house at 528 East Main Street (AVO.10). More research is recommended.) Ebenezer Crane (1766-1813)<sup>2</sup> married his wife, Abigail Burrell (1766-1848),<sup>3</sup> known as Nabby, in 1793. The couple had at least two children, Mary D. Crane (1802-1885)<sup>4</sup> and Ebenezer Crane 2d (1794-1861). Ebenezer Crane worked as a cordwainer (shoemaker).

In the mid-nineteenth century, this was the residence of George Leonard Crane (1825-1893),<sup>5</sup> grandson of Ebenezer and Abigail Crane and son of Mary D. and Ebenezer Crane, and his family. George L. Crane and his wife, Sarah Crafts Crane (1829-1907),<sup>6</sup> were married in 1846. George L. Crane worked as a shoemaker, as a carpenter, and as a cider manufacturer.<sup>7</sup> George L. Crane also served the town as constable and as the superintendent of the Avon cemetery.<sup>8</sup> In 1898, George's nephew, Harry

<sup>1</sup> Norfolk County Registry of Deeds Book 21, p. 47. Deed recorded in 1803.

<sup>2</sup> Findagrave.com Memorial #102208615. Accessed Nov. 7, 2022.

<sup>3</sup> <https://www.findagrave.com/memorial/102208731/abigail-crane>.

<sup>4</sup> Findagrave.com Memorial #86332437. Accessed Sept. 22, 2022.

<sup>5</sup> Findagrave.com Memorial #86332126. Accessed Sept. 22, 2022.

<sup>6</sup> Findagrave.com Memorial #86332128. Accessed Sept. 22, 2022.

<sup>7</sup> "George L. Crane Dead. Was One of the Oldest and Best Known of Avon's Citizens," *The Boston Globe*, 22 Dec. 1893, p. 5.

<sup>8</sup> Ibid.

# INVENTORY FORM B CONTINUATION SHEET

AVON

185 POND STREET

MASSACHUSETTS HISTORICAL COMMISSION

220 MORRISSEY BOULEVARD, BOSTON, MASSACHUSETTS 02125

Area(s) Form No.

AVO.65

L. Crane (the son of George's cousin Orlando) purchased the house.<sup>9</sup> Harry L. Crane lived here with his wife, Minnie, and their family. Harry L. Crane worked as a salesman in his father's (*i.e.*, Orlando B. Crane) grocery store. The house remained in the Crane family until 1917.<sup>10</sup>

Katherine and Henry Griffin owned the house from 1926 until 1953.<sup>11</sup> Henry Griffin worked as a poultry farmer.

## BIBLIOGRAPHY and/or REFERENCES

City Directories.

Findagrave.com.

Fisher, Nathaniel. "A Plan of the Town of Stoughton." 1794. Massachusetts State Archives.

"George L. Crane Dead. Was One of the Oldest and Best Known of Avon's Citizens." *The Boston Globe*. 22 Dec. 1893: 5.

Hanna, William F. *The Story of Avon*. Avon: Avon Centennial Committee, 1988.

Hodges, Joseph. "Plan of the Town of Stoughton." 1830. Massachusetts State Archives.

Massachusetts Census. Ancestry.com.

Massachusetts Vital Records.

Norfolk County Registry of Deeds.

Robinson, E. *Robinson's Atlas of Norfolk County, Massachusetts*. New York: E. Robinson, Publisher, 1888.

Sherman, G.A. *Atlas of Norfolk County*. New York: Comstock & Cline, 1876.

Talbot, Newton. [Buildings standing in Stoughton in 1775]. 1929. <https://stoughtonhistory.com/1775map.htm>.

Town of Avon. Tax Assessor records.

United States Census. Ancestry.com.

Walling, Henry Francis. *Map of Norfolk County, Mass.* Boston: Smith & Bumstead, 1858.



View looking west.



View looking northwest.

<sup>9</sup> Norfolk County Registry of Deeds Book 826, p. 221.

<sup>10</sup> Norfolk County Registry of Deeds Book 1375, p. 95

<sup>11</sup> Norfolk County Registry of Deeds Book 1705, p. 312 and Book 3227, p. 537.