

# FORM B – BUILDING

MASSACHUSETTS HISTORICAL COMMISSION  
MASSACHUSETTS ARCHIVES BUILDING  
220 MORRISSEY BOULEVARD  
BOSTON, MASSACHUSETTS 02125

## Photograph



View looking northeast.

## Locus Map

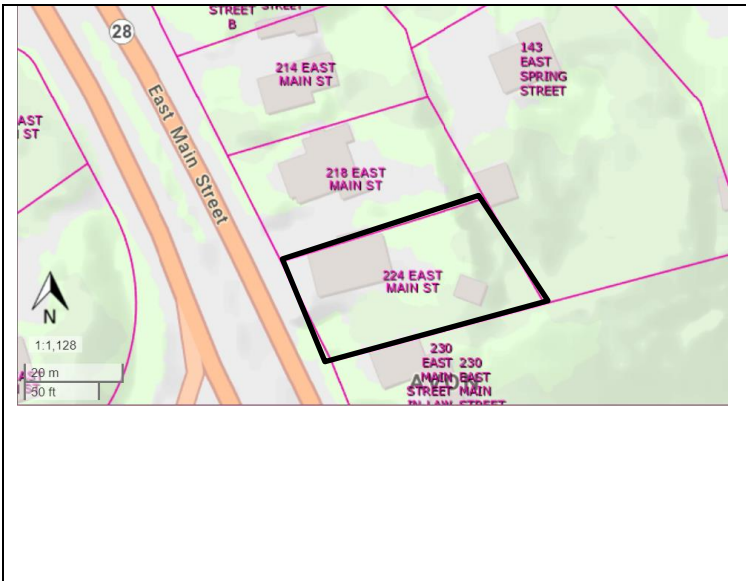

**Recorded by:** Stacy Spies

**Organization:** Avon Historical Commission

**Date** (month / year): December 2022

Assessor's Number USGS Quad Area(s) Form Number

D5/ 5/ 14/ /

Brockton

AVO.36

**Town/City:** Avon

**Place:** (neighborhood or village):

**Address:** 224 East Main St.

**Historic Name:** Thomas and Margaret Kenney House

**Uses:** Present: Single Family Dwelling

Original: Single Family Dwelling

**Date of Construction:** ca. 1890

**Source:** Deed

**Style/Form:** Victorian Eclectic

**Architect/Builder:** Not Known

**Exterior Material:**

Foundation: Stone, Cut

Wall/Trim: Wood Clapboard and Shingles / Wood Trim

Roof: Asphalt Shingle

**Outbuildings/Secondary Structures:** None Visible

**Major Alterations** (with dates): Replacement vinyl sash windows (late 20<sup>th</sup> C or early 21<sup>st</sup> C)

**Condition:** Good

**Moved:** no ☒ yes ☐ **Date:**

**Acreage:** 0.23

**Setting:** Located at a busy intersection along the four-lane, divided Route 28. Surrounding buildings are 2-story frame dwellings constructed during the 18<sup>th</sup>-20<sup>th</sup> centuries. The Harrison Boulevard connector to Highway 24 is located across the street.

# INVENTORY FORM B CONTINUATION SHEET

AVON

224 EAST MAIN ST

MASSACHUSETTS HISTORICAL COMMISSION

220 MORRISSEY BOULEVARD, BOSTON, MASSACHUSETTS 02125

Area(s) Form No.

AVO.36

☐ Recommended for listing in the National Register of Historic Places.

*If checked, you must attach a completed National Register Criteria Statement form.*

*Use as much space as necessary to complete the following entries, allowing text to flow onto additional continuation sheets.*

## ARCHITECTURAL DESCRIPTION:

*Describe architectural features. Evaluate the characteristics of this building in terms of other buildings within the community.*

Located on a level lot covered with lawn, the house is oriented to the west toward the street. A poured concrete retaining wall and steps separate the lot from the sidewalk. An asphalt-paved driveway leads from the street past the house's south elevation. Mature trees line the rear lot line.

The 1½-story frame house rests on a cut stone foundation and rises to a front-gabled roof with overhanging eaves adorned with a dentil course and a bargeboard featuring alternating rondels and attenuated rectangular panels. Compound jigsaw brackets are placed at each corner. A slender brick chimney rises from the east end of the south roof slope. The building is clad with wood clapboards trimmed with cornerboards and a skirtboard. The octagonal shingles in the gable peaks rise from a kicked shingle course aligned with the tops of the window frames. A hipped-roof porch supported by turned wood posts and jigsaw brackets wraps around the façade and south elevations. The wood valance spanning each porch bay is articulated with a pendant beside each bracket. A turned wood balustrade with newel posts encloses the porch. A pediment at the north end of the porch corresponds to the building's side-hall plan entrance. The pediment has overhanging eaves with a bargeboard that echoes the one at the roofline. A carved wood sunburst fills the pediment. The façade's first story, sheltered by the porch, contains a paneled wood door with a light in the top half at the north end and two tall 2/2 wood sash windows.

A 1½-story cross-gabled projection is attached to the east end of the north elevation. The projection is three bays wide and one bay deep with a paired window at the upper story. A small, leaded glass window located in the upper story of the north elevation illuminates the stairwell within. A 2-story octagonal tower capped with a steeply-pitched hip roof extends from the center of the south elevation. The decorative wood details on the side elevations mimic those on the façade. Unless otherwise noted, windows throughout the building are 1/1 wood sash with molded surrounds.

224 East Main Street is one of several houses in Avon that retain their decorative woodwork. While the form of the main block (front-gabled, gable-end cornice returns, wide frieze, 1½ stories) was common locally beginning circa 1850, the addition of the tower and decorative treatments place this building firmly among designs popular in the last decade of the 19<sup>th</sup> century. The house is nearly identical to 79 East High Street (AVO.18) and was likely constructed by the same builder. Although now altered with siding and the removal of decorative trim, 266 West Main Street appears to also be the same design.

## HISTORICAL NARRATIVE

*Discuss the history of the building. Explain its associations with local (or state) history. Include uses of the building, and the role(s) the owners/occupants played within the community.*

224 East Main Street was likely constructed circa 1890, the year in which Thomas Kenney purchased this parcel of land.<sup>1</sup> Born in Ireland, Thomas Kenney (1859-1934) immigrated to the United States at age three. In 1891, Kenney married Margaret Gorman (1860-1943) of Abington. Thomas Kenney worked in a shoe factory and Margaret Kenney worked as a self-employed seamstress, according to census records.

In 1913, John E. Ganley purchased the house.<sup>2</sup> John E. Ganley (1873-1953)<sup>3</sup> of Brockton and his wife, Jennie (Jane) Frances Walsh Ganley (1882-1975)<sup>4</sup> of Avon, were married in 1910 and soon moved to Avon. Active members of St. Michael's Parish,

<sup>1</sup> Norfolk County Registry of Deeds Book 644, p. 540.

<sup>2</sup> Norfolk County Registry of Deeds Book 1258, p. 289.

<sup>3</sup> Findagrave.com Memorial #160037045. Accessed Oct. 18, 2022.

<sup>4</sup> Findagrave.com Memorial #160037044. Accessed Oct. 18, 2022.

# INVENTORY FORM B CONTINUATION SHEET

AVON

224 EAST MAIN ST

MASSACHUSETTS HISTORICAL COMMISSION

220 MORRISSEY BOULEVARD, BOSTON, MASSACHUSETTS 02125

Area(s) Form No.

AVO.36

the couple had three children, who continued to live here as adults. John E. Ganley worked as a cutter at the Diamond Shoe Company in Brockton.<sup>5</sup> In 1927, John E. Ganley was elected to the Avon Board of Assessors and served until 1950.<sup>6</sup> John E. Ganley played a role in one of the most famous trials in American history; Ganley served as a juror in the trial of Sacco and Vanzetti, which took place at the Dedham Superior Courthouse in 1921.<sup>7</sup> Jennie Ganley owned the house until 1968.<sup>8</sup>

## BIBLIOGRAPHY and/or REFERENCES

Findagrave.com.

Hanna, William F. *The Story of Avon*. Avon: Avon Centennial Committee, 1988.

Massachusetts Vital Records.

Norfolk County Registry of Deeds.

Robinson, E. *Robinson's Atlas of Norfolk County, Massachusetts*. New York: E. Robinson, Publisher, 1888.

Sanborn Fire Insurance Atlas. 1916.

Town of Avon. Tax Assessor records.

United States Census. Ancestry.com.

World War II Draft Registration Cards. Ancestry.com.



View looking southeast.



Detail, porch.

<sup>5</sup> World War II Draft Registration Card. Ancestry.com. Accessed Oct. 18, 2022.

<sup>6</sup> Hanna: 97.

<sup>7</sup> Hanna: 97.

<sup>8</sup> Norfolk County Registry of Deeds Book 4560, p. 331.