

FORM B – BUILDING

MASSACHUSETTS HISTORICAL COMMISSION
MASSACHUSETTS ARCHIVES BUILDING
220 MORRISSEY BOULEVARD
BOSTON, MASSACHUSETTS 02125

Assessor's Number USGS Quad Area(s) Form Number

D5/ 2/ 8/ /	Blue Hills		AVO.48
-------------	------------	--	--------

Town/City: Avon

Place: (*neighborhood or village*):

Photograph



View looking northwest.

Address: 70 Gill Street

Historic Name: Robert and Susan Wilson House

Uses: Present: Single Family Dwelling

Original: Single Family Dwelling

Date of Construction: ca. 1860

Source: Deed

Style/Form: No Style

Architect/Builder: Not Known

Exterior Material:

Foundation: Not visible

Wall/Trim: Wood vertical boards / Wood Trim

Roof: Asphalt Shingle

Outbuildings/Secondary Structures: None

Major Alterations (*with dates*): Vertical Boards (20th C?); Replacement vinyl sash windows (late 20th C or early 21st C)

Condition: Poor

Moved: no ☒ yes ☐ **Date:**

Acreage: 0.64

Setting: Located on a suburban residential street.
Surrounding houses constructed mid-19th C – mid-20th C.

Locus Map

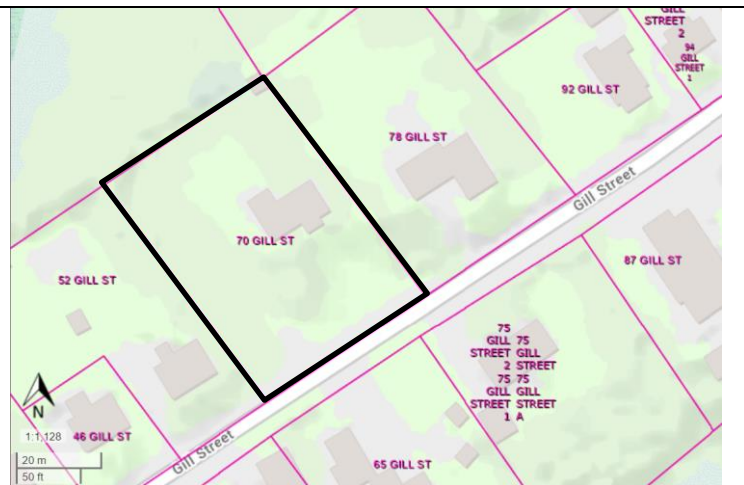

Recorded by: Stacy Spies

Organization: Avon Historical Commission

Date (*month / year*): December 2022

INVENTORY FORM B CONTINUATION SHEET

AVON

70 GILL STREET

MASSACHUSETTS HISTORICAL COMMISSION

220 MORRISSEY BOULEVARD, BOSTON, MASSACHUSETTS 02125

Area(s) Form No.

AVO.48

☐ Recommended for listing in the National Register of Historic Places.

If checked, you must attach a completed National Register Criteria Statement form.

Use as much space as necessary to complete the following entries, allowing text to flow onto additional continuation sheets.

ARCHITECTURAL DESCRIPTION:

Describe architectural features. Evaluate the characteristics of this building in terms of other buildings within the community.

Located on level lot covered with lawn, the house is oriented to the south toward the street. An asphalt-paved driveway is located at the southwest corner of the lot. Mature trees fill the rear of the lot. The house consists of a 1½-story main block, a 1-story, gable-roof rear block, and a 1-story, flat-roofed addition at the southwest corner of the building that connects the two earlier blocks. Based on its appearance, the building was updated in the last quarter of the 19th century and the connector added in the mid-late 20th century.

The 1½-story main block has a side-gabled roof with overhanging eaves. A slender brick interior chimney rises from the north (rear) roof slope. The façade features an off-center entrance containing a paneled wood door with a single light filling the top half. Large jigsawed wood brackets support a shallow roof above the entrance. The entrance is contained within a projecting bay that connects to a gable dormer above via a flared roof. The pedimented dormer contains a pair of windows with decorative wood brackets under the overhanging eaves. A wide bay window with a hipped roof and bracketed eaves fills the east end of the façade. The side (east) elevation is two bays deep with a single window centered in the gable peak. The rear block, located near the northeast corner of the main block is one bay deep and capped with a side-gabled roof with overhanging eaves. A shed-roofed projection is attached to its rear (north) elevation. Windows throughout the main block and rear block are 1/1 wood sash with exterior, metal-frame storm windows. Window surrounds are constructed of wide, flat wood trim.

The one-story connector forms the southwest corner of the house and is attached to the west elevation of the main block and the south elevation of the rear block. This connector rests on a concrete block foundation. The south elevation contains a trio of sash windows and a single sash window. The west elevation contains a single sash window, two hopper windows, and an entrance with a Colonial Revival-style metal storm door. A wood deck constructed of pressure-treated dimensional lumber is attached to the west elevation.

HISTORICAL NARRATIVE

Discuss the history of the building. Explain its associations with local (or state) history. Include uses of the building, and the role(s) the owners/occupants played within the community.

70 Gill Street was likely constructed circa 1860, the year in which Robert Wilson purchased 5/8 acre of land “on the northerly side of the new road leading from the Lower Road” (i.e., East Main Street).¹ Robert Wilson (1830-1867)² and his wife Susan (1832-1908)³ were born in Ireland and arrived in Stoughton by the time of the 1855 census. The couple was married in 1853. Robert Wilson worked as a bootmaker and the couple lived here with their children. In 1870, Susan Wilson married again to John Sweet (1833-1911), an Irish bootmaker like her first husband. As the Wilson children grew up and married, they remained at this residence.⁴ Catherine Wilson married Sanford K. Parrish, who worked at a shoe factory. Catherine Wilson Parrish operated a variety store. The property was passed down through the family and sold in 1943.⁵

¹ Norfolk County Registry of Deeds Book 291, p. 234 [466].

² Findagrave.com Memorial #70191197. Accessed Oct. 20, 2022.

³ Findagrave.com Memorial #161652606. Accessed Oct. 20, 2022.

⁴ The 1876 map identifies the house as belonging to “M. Toomey.” Census records indicate that a Mary Toomey did live on this street during the 1870s, but there is no record her ownership of a house. The Wilson/Sweet family are included in census records as residents of Gill Street during their entire ownership of the house.

⁵ Norfolk County Registry of Deeds Book 2456, p. 320.

INVENTORY FORM B CONTINUATION SHEET

AVON

70 GILL STREET

MASSACHUSETTS HISTORICAL COMMISSION
220 MORRISSEY BOULEVARD, BOSTON, MASSACHUSETTS 02125

Area(s)	Form No.
	AVO.48

BIBLIOGRAPHY and/or REFERENCES

City Directories.
Findagrave.com.
Massachusetts Vital Records.
Massachusetts Census. Ancestry.com.
Norfolk County Registry of Deeds.
Robinson, E. *Robinson's Atlas of Norfolk County, Massachusetts*. New York: E. Robinson, Publisher, 1888.
Sherman, G.A. *Atlas of Norfolk County*. New York: Comstock & Cline, 1876.
Town of Avon. Tax Assessor records.
United States Census. Ancestry.com.
Walling, Henry Francis. *Map of Norfolk County, Mass.* Boston: Smith & Bumstead, 1858.



Façade. View looking north-northwest.



View looking north toward ell.



Assessor's photograph showing clearer view of connector.